

GOLD SERIES GARAGE DOORS



THE ULTIMATE SAWMILL CREEK GARAGE DOOR

It all begins with the natural beauty of clear grade Western Red Cedar, known for its rich grain and warm palette that ranges from light amber to deep honey brown. Elegantly textured, this high quality wood speaks of prestige and pride of ownership. In addition to its good looks, Western Red Cedar contains natural oils that help preserve the wood for years to come.

Sawmill Creeks' Gold Series are our highest quality garage doors, offering an unlimited choice of available designs, or Sawmill Creek will build a custom design from a drawing or sketch.



GARAGE DOOR SPECIFICATIONS

Clear grade Western Red Cedar standard face material. Available in 4" or 6" V-Groove, 4" Bead-Board, 4" Flush Face or flat paintable surface. African Mahogany available as an option.

Layered Western Red Cedar or Mahogany perimeter trim boards 5/8" thick; 8 1/2" bottom rail; and 5 1/4" outer perimeter trim boards.

Solid SPF frame, 15/16" thick with 5 mm exterior grade plywood on interior.

The interior surface material is puttied and sanded. The interior surface can be stained or painted.

Standard door thickness is 2 5/16" or 2 1/8" depending on surface material.

Moisture control design features built into the garage doors to prevent moisture damage. See drawing at right for details.

Bottom astragal is EPDM rubber mounted in an extruded aluminum retainer.

Clear grade Western Red Cedar door stops are provided with a choice of white, gray, tan or brown vinyl colors.

DOOR SIZES

Doors will be built to the size indicated on the customer drawing. Doors are sizeable and built in 1/4" increments within the below widths and heights.

Widths: 4' to 18' 6"
Heights: 6' 6" to 10' 6"

WOOD SPECIES

All standard exterior face material is Western Red Cedar.

Clear grade, old growth Western Red Cedar generally has a mixture of light and dark grains, which is the true natural and beautiful look of Western Red Cedar. The natural characteristics of cedar make it a preferred material for exterior applications. Western Red Cedar contains natural oils that act as preservatives to help the wood resist insect attack and decay. Properly finished and maintained, Western Red Cedar will stand up to the elements for many years.

African Mahogany is available as an option along with other wood species upon request. Also available is "Stain Grade Select", which offers the customer consistence in color tones.

WINDOW DETAIL

The standard available glass options are 1/8" clear double strength glass, 1/2" thick insulated glass and the below 1/8" glass material:

- Bronze tint clear double strength
- Glacier glass
- Tempered glass
- Custom glass available upon request

The windows are wet glazed to the structure using acrylic latex. Standard exterior profile muntins with interior muntins, give the appearance of true divided lites. The interior muntins, with glass stop, have a 10 degree bevel for moisture control.

FINISHING

The garage doors come unfinished. As an option, to preserve the natural beauty of our garage doors, Sawmill Creek offers factory applied staining and painting. We will professionally apply 1,2 or 3 coats depending on your needs.

We use either Sikken's® brand stains or Sherwin Williams® paints.

DOOR CONSTRUCTION

Moisture is the number one element that can destroy any wood product. We incorporate several details into the construction of our Gold Series doors to prevent moisture damage.

A patented designed drip cap to cause water to run off of the door. The drip cap is a board with a 45 degree bevel recessed into the door face and applied on the top of the horizontal bottom trim board. The purpose of the drip cap is to deflect water away from the end grain of the door in order to reduce rotting.

Vent holes are added to the side of the doors to allow unwanted moisture to escape the doors.

The top of the trim board under the window has a 10 degree bevel to allow moisture to run away from the door.

The door has been designed with no exposed end grain on the bottom of the door.

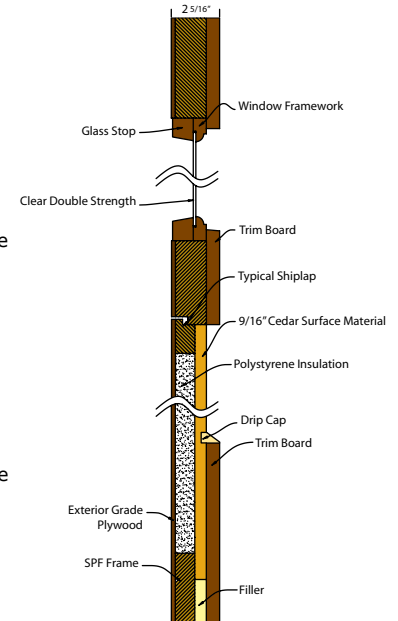

GOLD GARAGE DOOR OPTIONS

Factory Applied Finish: To assure the proper finishing of your garage doors and preserve the natural beauty of your garage doors, Sawmill Creek offers factory applied finishing.

Stain Grade Select: Stain Grade Select allows you the option of getting your Western Red Cedar garage doors with consistency in color tone.

Decorative Hardware: You can add character to the exterior of your garage doors with Sawmill Creek's authentic looking decorative hardware.

Custom Designs: Sawmill Creek can work with you on custom designs from professional drawings or just a sketch. Sawmill Creek can create the doors you want in our standard clear grade Western Red Cedar or woods such as Mahogany or Spanish Cedar.

2 Week Quick Ship Program: The basics of this program allow you to order garage doors requesting a two week lead time.

5 YEAR LIMITED WARRANTY

Sawmill Creek offers a 5 Year Limited Warranty for its Gold Series garage doors. Ask your local dealer for details or go to "Sawmillcreekdoors.com".

Distributed By: